

# @lgood

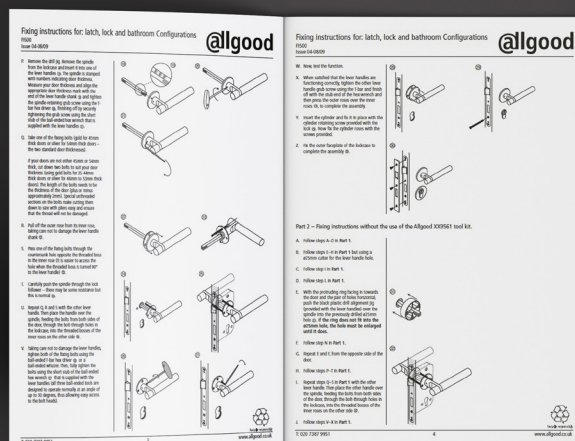

**O&M** - Construction and Handover Phase

## quadaxial fixing instructions



During the construction phase it is essential that Allgood products are fitted using the fitting instructions provided with each product. If an Allgood ironmongery schedule has also been prepared this should be referred to making special reference to any remarks pertaining to particular door sets.

Once installed the product fixings should be tightened using a hand tool such as the allen key provided or poszi drive screw drivers of the correct gauge and size. Power tools should not be used to fix Allgood products – this can result in over tightening. Once screws, grub screws and fixing are secured all cover plates, roses and caps should be installed. Allowing for a final clean to removed any site debris, such as wood or metal shavings.

protected lever handle



Trim and decorative hardware such as lever handles, pull handles, panic hardware and push plates should be covered with the required protection during the remaining construction phase. This will ensure that the finish does not become damaged and the operation of the product is not compromised. If these covers are not installed site debris can become lodged inside the unit impairing performance and there is potential for metal surfaces to become contaminated with foreign particles (particularly from adhesives and paint), which can result in the deterioration of the substrate finish.

lever neck and grub screw



Prior to hand over the products should have their protection removed and all fixings should be readjusted to ensure that they are fitted as per the fixing instructions provided. All products should be cleaned, as per their respective instructions or as detailed within the "O&M Manual – Care of Finishes" section), and any site damage rectified. Lever handles and pull handles should be checked that all bolt through fixings and grub screws are tightened and installed correctly.



**O+M Manual**

Allgood provide spare parts and additional fixing screws for all of its products. These can be ordered from any Allgood office or international distributor. Copies of our operations and maintenance manuals are available online and should be downloaded and issued to the client's facilities teams during this phase



Many Allgood products are 'maintenance free' however over time fixings can become loose and annual checks should be carried out to ensure the products are installed as per the product fixing instructions and that they have not become damaged during use. Some Allgood items do require regular maintenance and the Allgood operation and maintenance manual should be referred to. Should any Allgood item still within warranty become faulty or damaged please contact one of our UK offices or international distributors.



**Allgood plc**

2 Stephen Street  
London W1T 1AN,  
Telephone: 020 7387 9951  
Facsimile: 020 7380 1232  
E-mail: [info@allgood.co.uk](mailto:info@allgood.co.uk)  
Website: [www.allgood.co.uk](http://www.allgood.co.uk)

63-83 Brearley Street  
Birmingham B19 3NT  
Telephone: 0121 359 4415  
Facsimile: 0121 359 5832  
E-mail: [info@allgood.co.uk](mailto:info@allgood.co.uk)  
Website: [www.allgood.co.uk](http://www.allgood.co.uk)

76 King Street  
Manchester M2 4NH  
Telephone: 0161 834 6717  
E-mail: [info@allgood.co.uk](mailto:info@allgood.co.uk)  
Website: [www.allgood.co.uk](http://www.allgood.co.uk)

The Wright Business Centre  
1 Lonmay Road, Glasgow G33 4EL  
Telephone: 0141 773 6298  
Facsimile: 0141 771 6569  
E-mail: [info@allgood.co.uk](mailto:info@allgood.co.uk)  
Website: [www.allgood.co.uk](http://www.allgood.co.uk)